

FRONT DOOR INSTALLATION

IMPORTANT: THE WINDOW VISOR MUST BE FITTED INTO THE SAME CHANNEL AS THE DOOR WINDOW GLASS. THE DOOR WINDOW MUST BE FULLY DOWN WHEN INSTALLING THE WINDOW VISOR

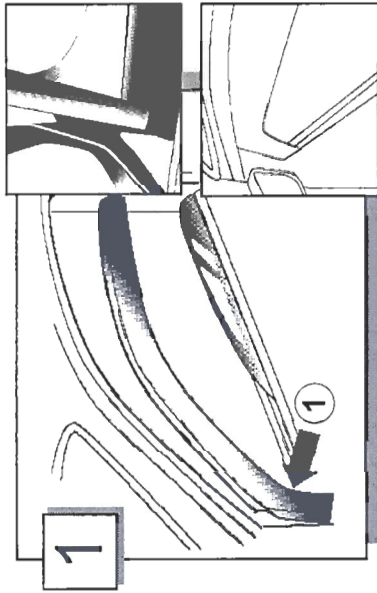

- Fit front end of **WINDOW VISOR** first at the mirror sail area of the door.

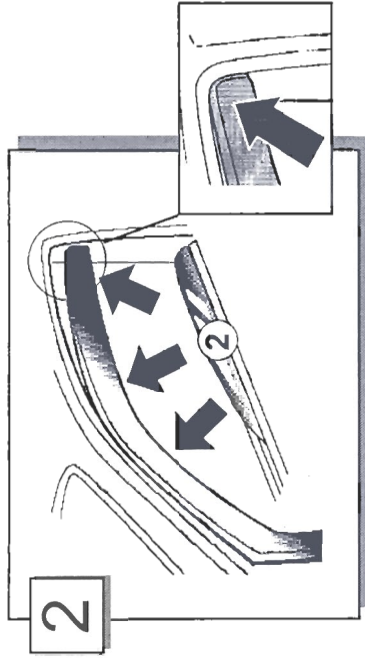

- Fit rear section of **WINDOW VISOR** into channel, as shown.

INSTALLATION INSTRUCTIONS

IN-CHANNELTM SLIMLINE WINDOW VISOR

IMPORTANT

- When fitting the **WINDOW VISOR** it will be necessary to bend the **WINDOW VISOR** to enable fitment into the rear section of the door channel.

CARE MUST BE TAKEN AS THE PRODUCT COULD BREAK.

- Once installed gently push the **WINDOW VISOR** upwards into the window channel.
- The bottom edge of the part must rest on the top of the outside door weatherstrip.

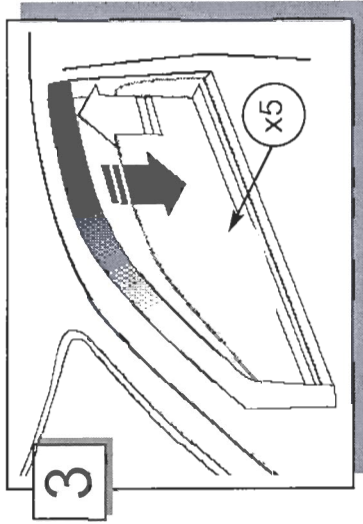

- Wind window up and down several times, to ensure a secure fit.
- To remove gently pull **WINDOW VISOR** out from rear of the door and remove.

IMPORTANT

- The rubber window trim may need to be massaged to allow the window and **WINDOW VISOR** to seat correctly in the window channel.

To Clean: Use mild detergent and water solution. (Do **NOT** use solvents).

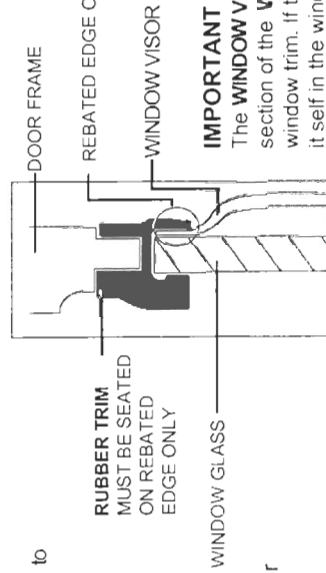

IMPORTANT

The **WINDOW VISOR** must be fitted such that only the rebated section of the **WINDOW VISOR** is located under the rubber window trim. If this is not done then the window may not seat itself in the window rubber correctly.

REAR DOOR INSTALLATION

IMPORTANT: THE WINDOW VISOR MUST BE FITTED INTO THE SAME CHANNEL AS THE DOOR WINDOW GLASS
THE DOOR WINDOW MUST BE FULLY DOWN WHEN INSTALLING THE WINDOW VISOR

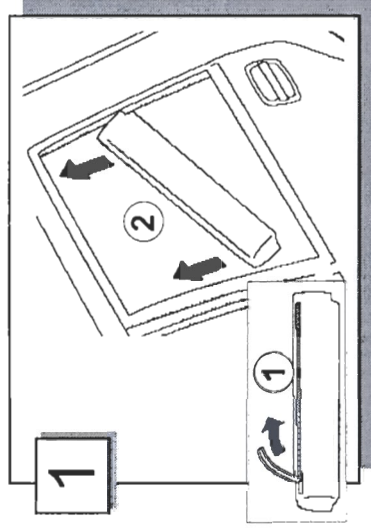

- Peel lining of double side tape as shown
- Fit front and rear of WINDOW VISOR into the window channel as shown.

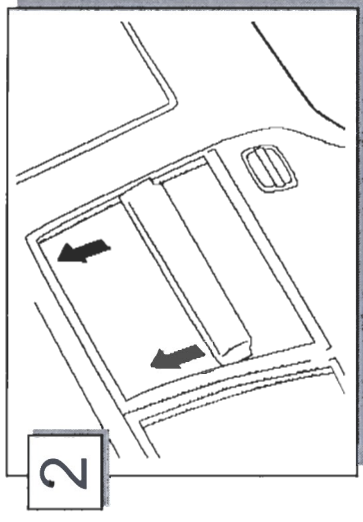

- Rotate WINDOW VISOR until it's on horizontal positions to the door. Once in place gently push upwards into window channel.

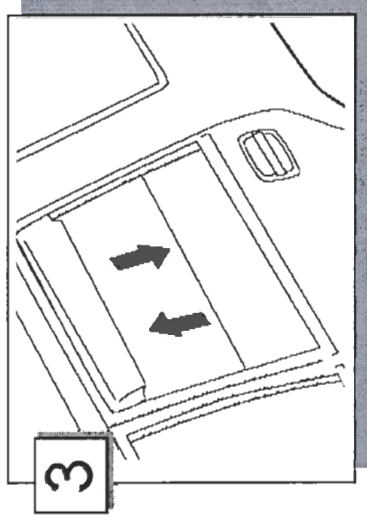

- Wind window up and down several times, to ensure a secure fit.

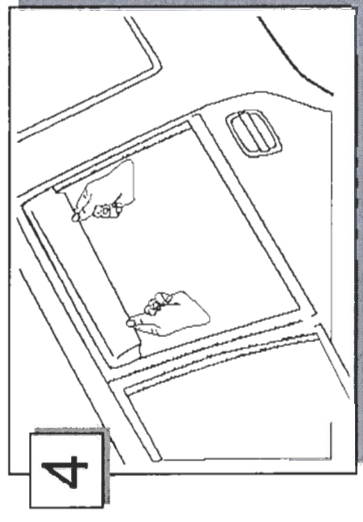

- To remove gently pull downwards and slide off.
IMPORTANT
Remove carefully to avoid damage to WINDOW VISOR and vehicle.

INSTALLATION INSTRUCTIONS

IN-CHANNEL™ SLIMLINE WINDOW VISOR

To Clean: Use mild detergent and water solution. (Do **NOT** use solvents).